

Fluorescent lampholders

G13 End fixing lampholders

26.422



pkg.	wt.	part no.
500	7 g	26.422.1110.50

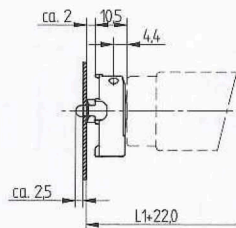
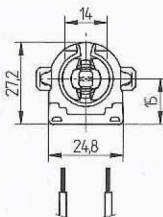
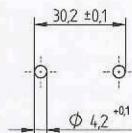

Snap in pins with spring

Housing: PC

Rotor: PBT

Lampholder thickness: 10.5 mm

Approval: additional cULus [660W /600V]

Wiring: through the body

- One lampholder with leaf spring allows a lamp length tolerance compensation of 2 mm

Find accessories on page: [01] 39

L1+22.0: Recommended dimension is based on use of one lampholder with and one lampholder without spring. The final distance should be governed by the dimensions of the respective lamps and luminaires.

T 130

Tm 110



CAD

i

[01] 3...