

Lampholders for compact fluorescent lamps

26.719

G23

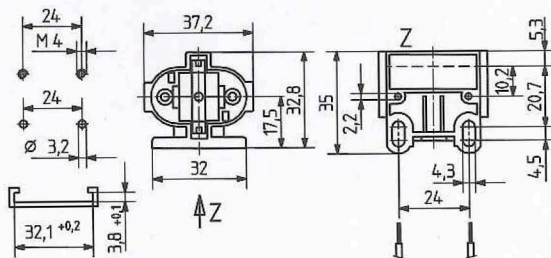
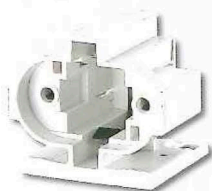

pkg.	wt.	part no.
250	14 g	26.719.4355.50

For lamps TC-S

Screw fixing horizontally

Push in fixing

Housing: PBT

Wiring: rear entry wiring

- Screw fixing: long holes: $\varnothing 4.3 \times 4.5$ mm for screws ISO 1207-M4
- Holes: $\varnothing 2.2$ mm for self-tapping screws with locating groove ISO 1481 - ST 2.9 - F/ISO 4753 - SC
- Into locating grooves in fixing plate

Find accessories on page: [03] 23, [03] 24, [03] 25

T 140

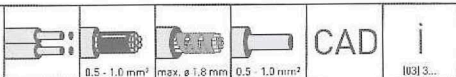

W313...